

ORCHARD HOLDINGS LLC  
MEADOW ROAD  
BLOCK 366A, LOT 16  
TOWNSHIP OF EDISON  
MIDDLESEX COUNTY, NEW JERSEY  
NJDEP SRP PH# 632481

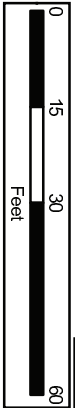

FIGURE 10A  
PRODUCT THICKNESS  
ISO-CONCENTRATION MAP  
February 2, 2018

- Legend
- Monitor Well Location
  - Site Boundary
  - Former AST (Contents Unknown)
  - Product Thickness Iso-concentration (feet)

Note:  
Monitoring wells MW-1, MW-2, MW-4, MW-5 and MW-6 all had a sorbent sock installed in well prior to product measurement. Sorbent socks were removed from wells.

*This map was developed using New Jersey Department of Environmental Protection Geographic Information System digital data, but this secondary product has not been verified by NJDEP and is not state-authorized.*

Coordinate System: NAD 1983 StatePlane New Jersey FIPS 2900 Feet  
Projection: Transverse Mercator  
False Easting: 492,126,000  
False Northing: 0.0000  
Central Meridian: -74.5000  
Scale Factor: 0.9999  
Latitude Of Origin: 38.8333  
Units: FootUS



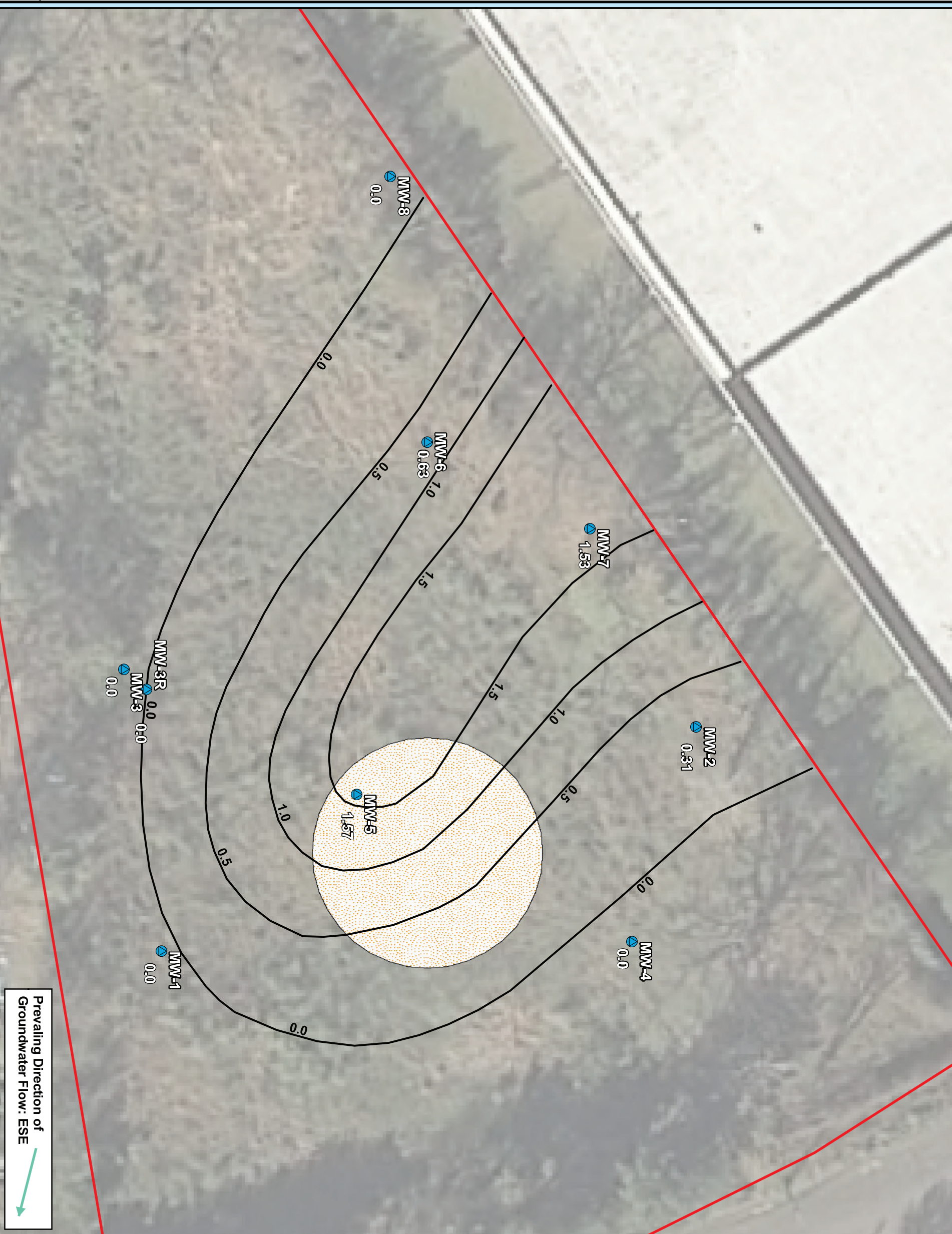



**Engineering and Science, Inc.**  
(a DBA of Partner Assessment Corp., a NJ engineering firm)  
611 Industrial Way West  
Edinburg, NJ 07724  
Certificate of Authorization No. 24GA27989800  
www.partneresi.com

Sources: NJDEP and NJGIN GIS Data;  
DPK Consulting Survey Data  
Partner field measurements

DRAWN BY	BPT	SCALE
		1 in = 30 ft
Job No: 02726100000		DATE
File Name: Fig 10A-Oil Iso-concentration Map		02/22/2018



ORCHARD HOLDINGS LLC  
MEADOW ROAD  
BLOCK 366A, LOT 16  
TOWNSHIP OF EDISON  
MIDDLESEX COUNTY, NEW JERSEY  
NJDEP SRP PI# 632481

FIGURE 10B  
PRODUCT THICKNESS  
ISO-CONCENTRATION MAP  
February 15, 2018

- Legend
- Site Boundary
  - Former AST (Contents Unknown)
  - Monitor Well Location
  - Product Iso-concentration Plume 2-15-18

This map was developed using New Jersey Department of Environmental Protection Geographic Information System digital data, but this secondary product has not been verified by NJDEP and is not state-authorized.

Coordinate System: NAD 1983 StatePlane New Jersey FIPS 2900 Feet  
Projection: Transverse Mercator  
False Easting: 492,126,000  
False Northing: 0.0000  
Central Meridian: -74.5000  
Scale Factor: 0.9999  
Latitude Of Origin: 38.8333  
Units: FootUS

0153060

Feet



**PARTNER**

Engineering and Science, Inc.  
(a DBA of Partner Assessment Corp, a NJ engineering firm)

611 Industrial Way West  
Edinotown, NJ 07724  
Certificate of Authorization No. 24GA27989800

Tel.: 732.380.1700  
Fax.: 732.380.1701  
www.partneresi.com

Sources: NJDEP and NJGIN GIS Data;  
DPK Consulting Survey Data  
Partner field measurements

DRAWN BY  
BPT

SCALE  
1 in = 30 ft

DATE  
02/22/2018

Job No: 02726100000  
File Name: Fig 10B-Oil Iso-concentration Map

